



ANDROID DEVELOPMENT #4

@brmlab

COMPATIBILITY

- Support library v4

- /libs/android-support-v4.jar

- Backwards support of important components to API 4

ACTIVITY VS. FRAGMENT

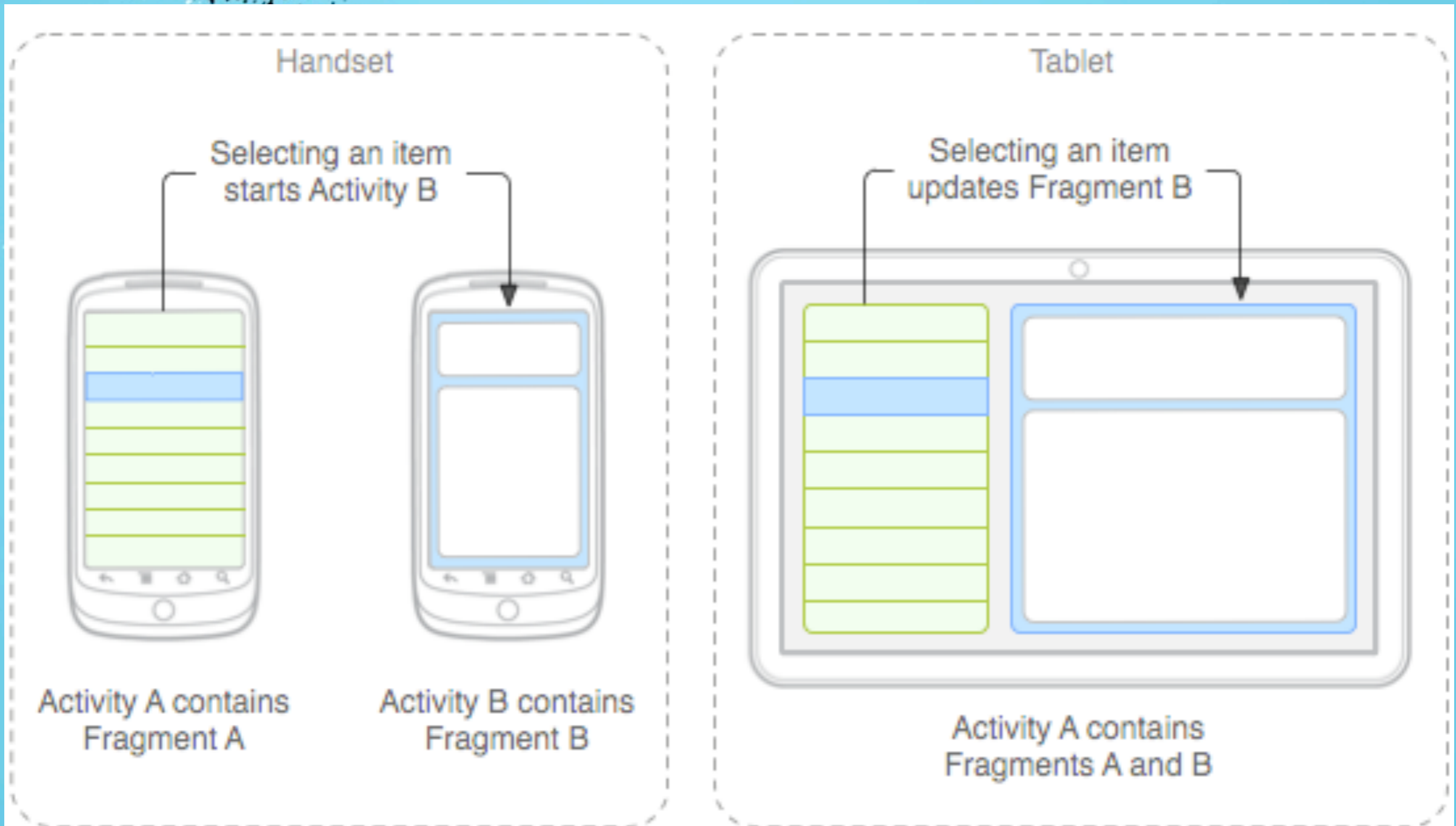

ACTIVITY

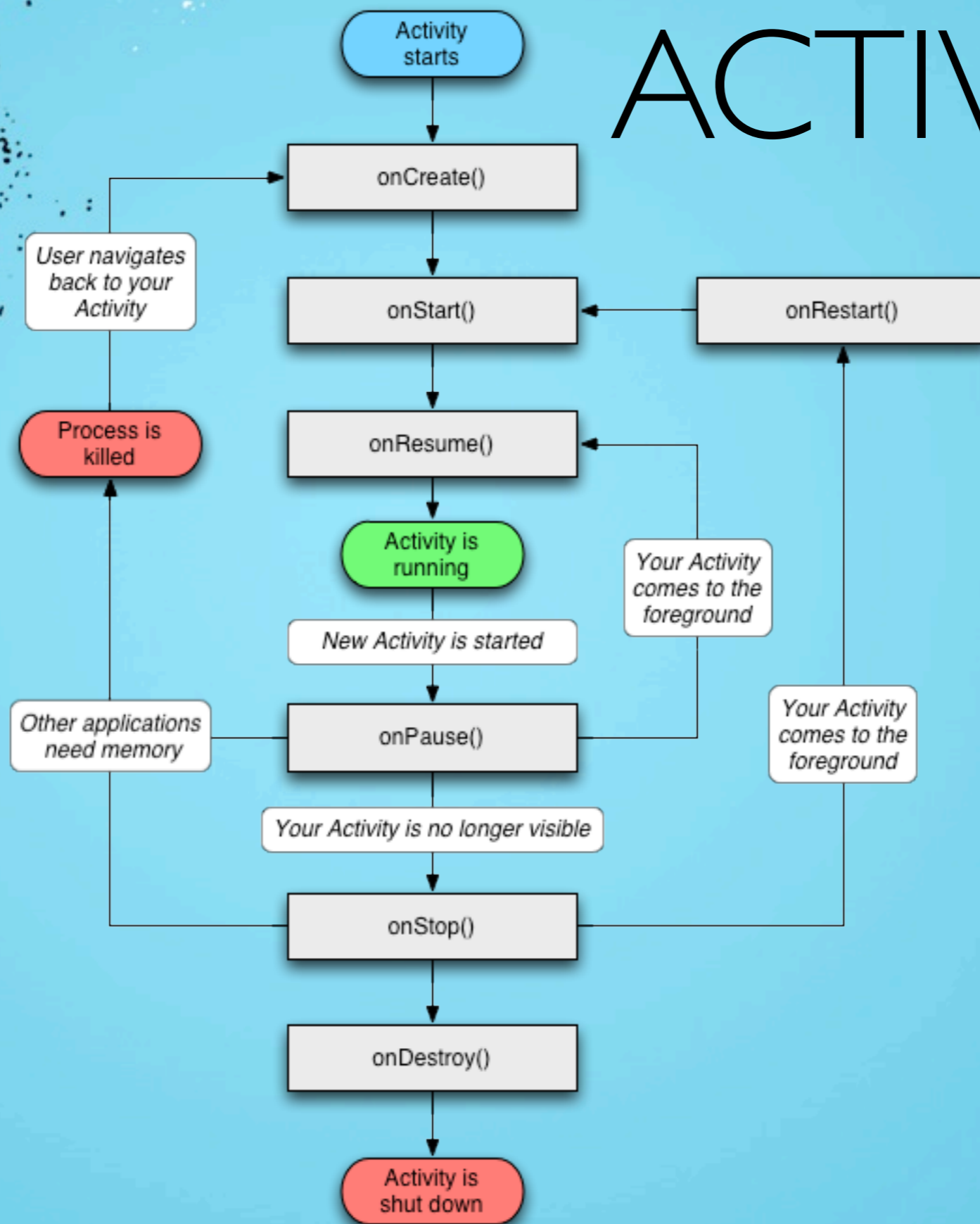

FRAGMENT

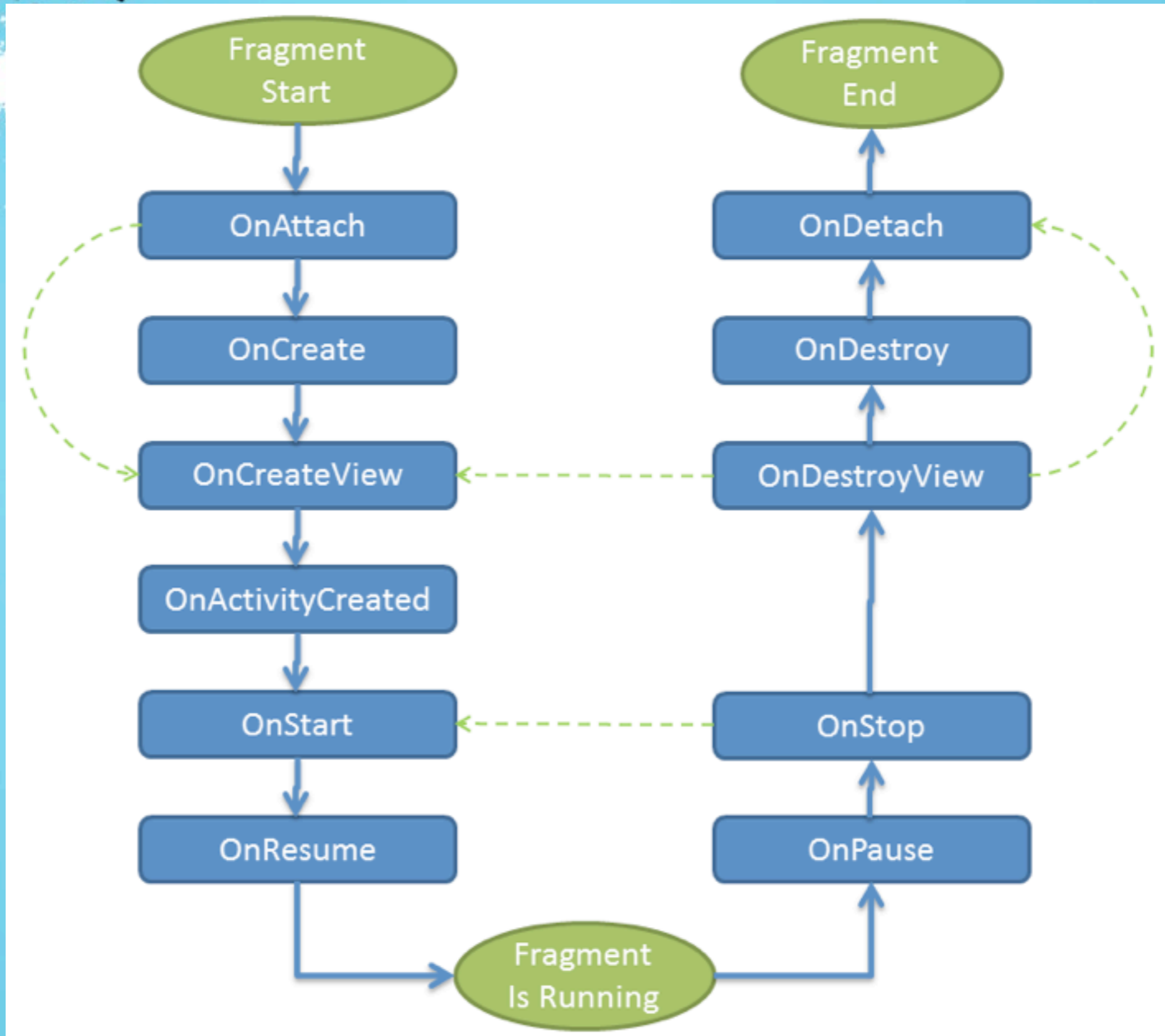

USER INTERFACE

- Design Guidelines
- Icon Guidelines
- Large palette of standard components
- Gestures
- Compatibility
- Navigation patterns

ICON GUIDELINES



ACTIONBAR

Native since API 11

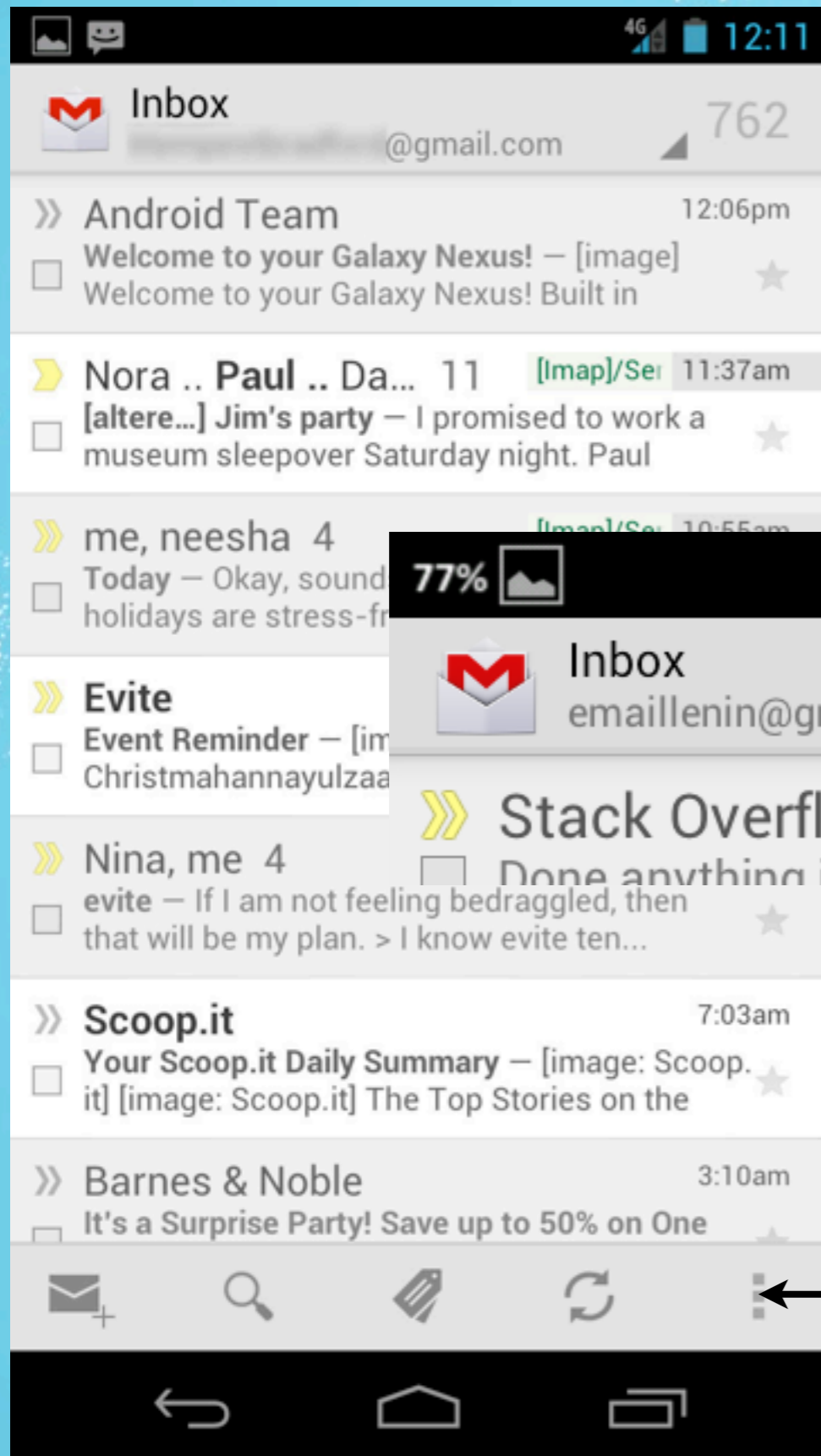

Landscape - items fits on top

With Split ActionBar

ACTIONBAR SHERLOCK

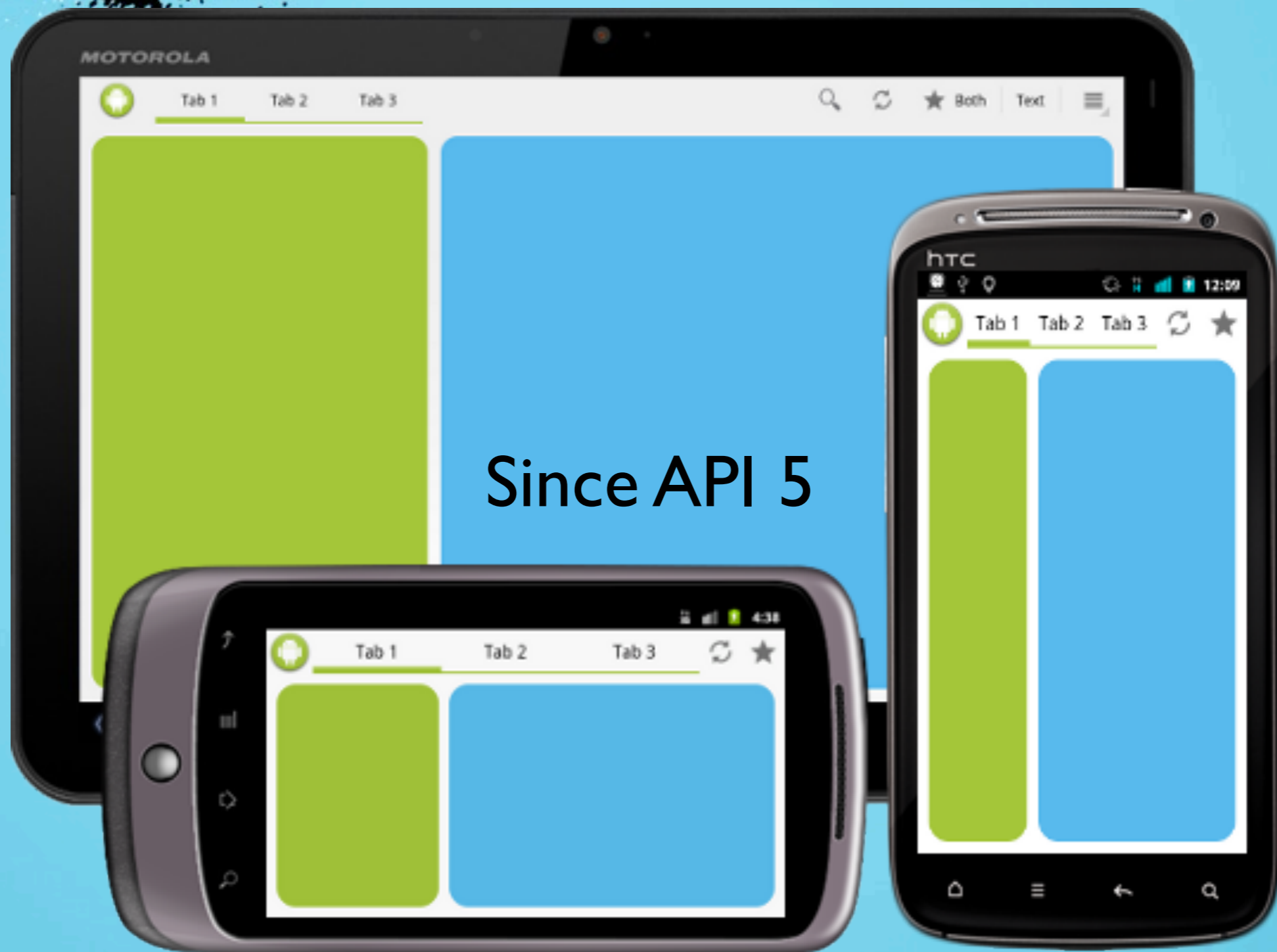

Since API 5

OPTIONS MENU

$X > \text{API } 10$

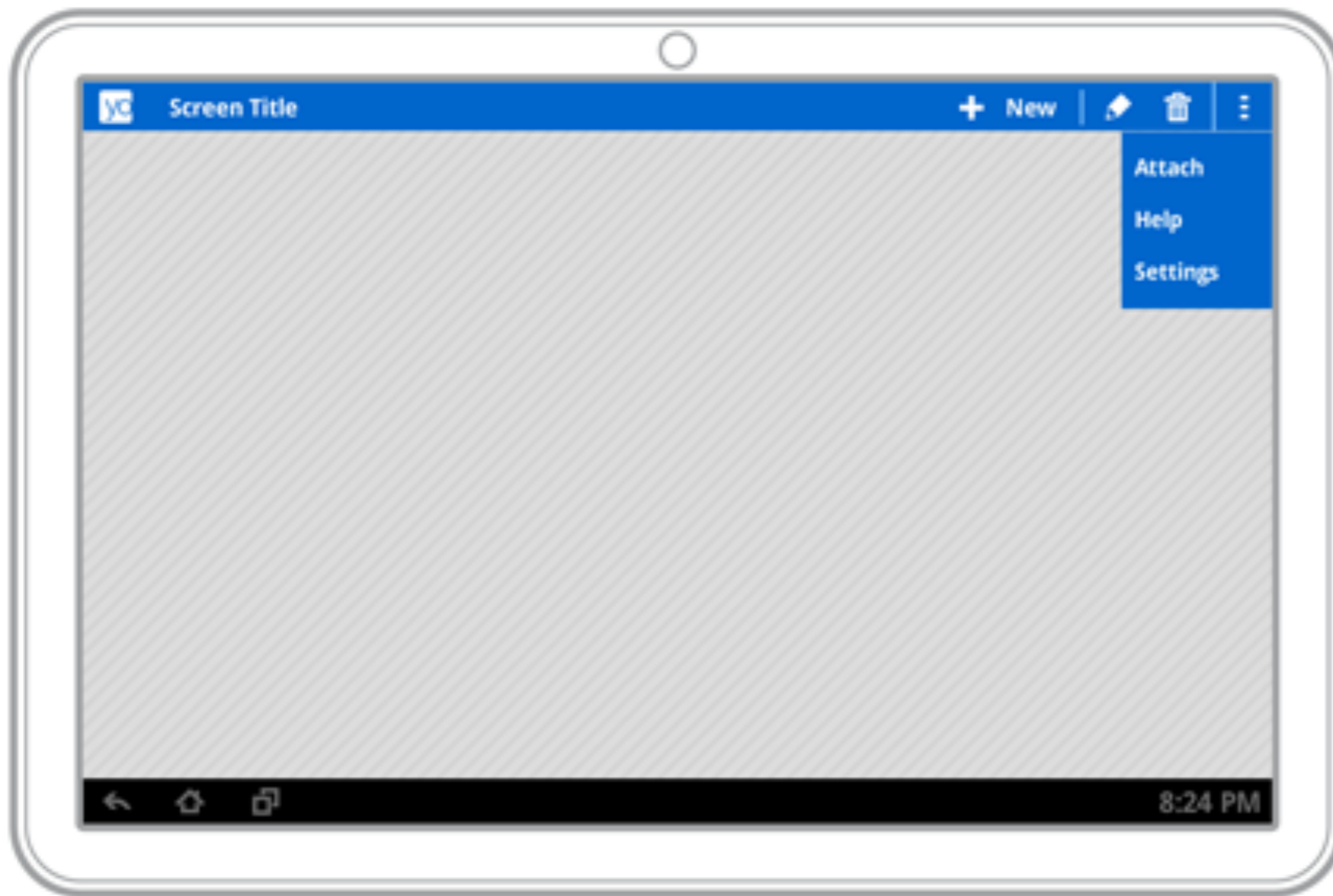

$X < \text{API } 10$



NAVIGATION

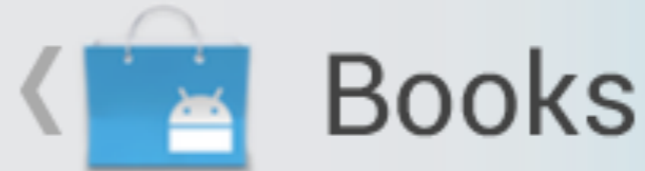

- Back and Up pattern

- Back button (bottom navigation controls)

- Up button (part of ActionBar)

STANDARD UI COMPONENTS

LISTS / EXPANDABLE LISTS

SCROLL VIEW

FORM WIDGETS

GRAPHICS (IMAGE VIEW,
GALLERY, MEDIA CONTROLLER,
VIDEO VIEW)

DATE (+TIME) PICKERS

TRANSITIONS

GESTURES

CANVAS (SURFACE, TEXTURE)

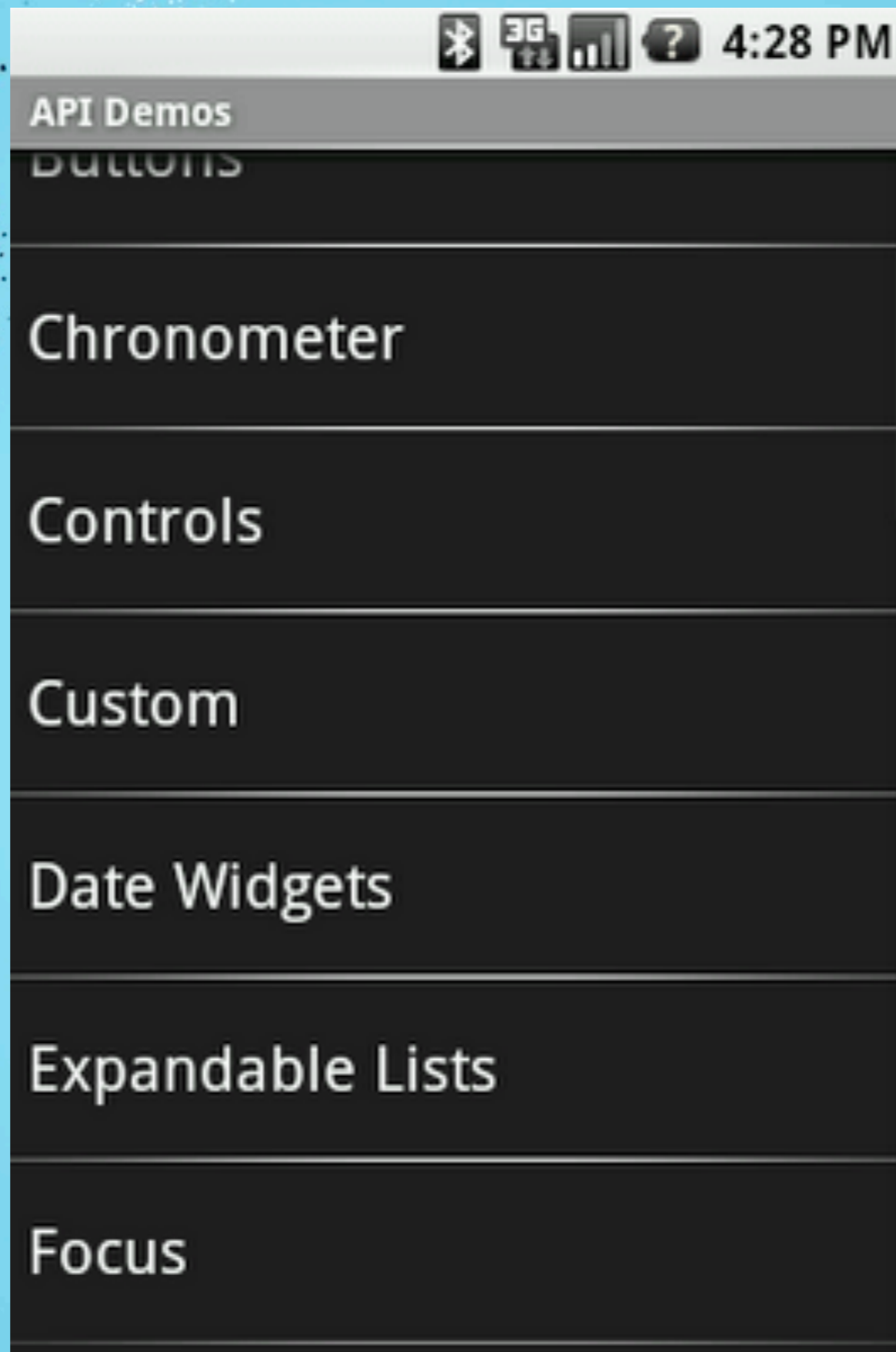

LISTS

EXPANDABLE LISTS

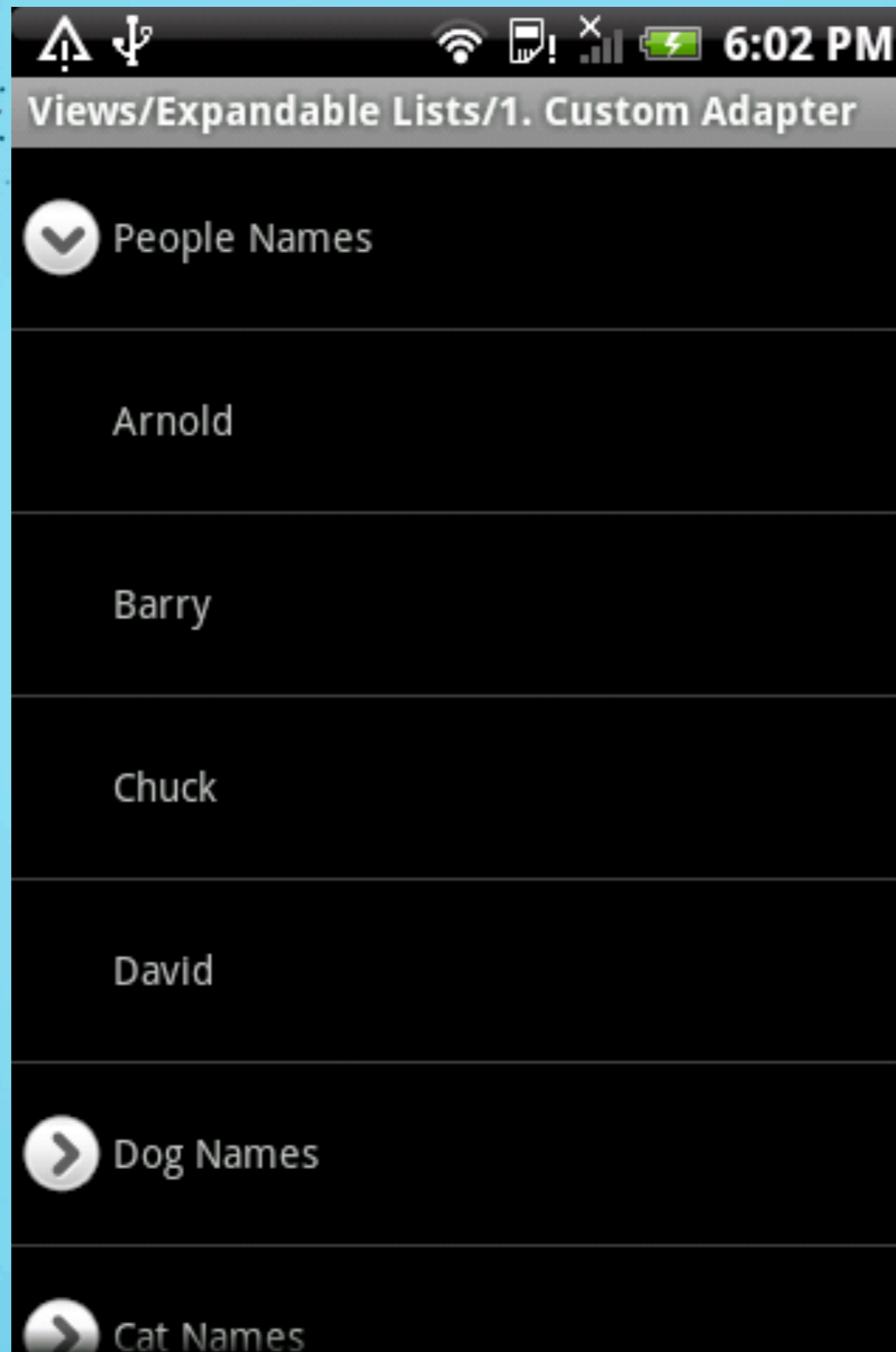

LIST ADAPTER

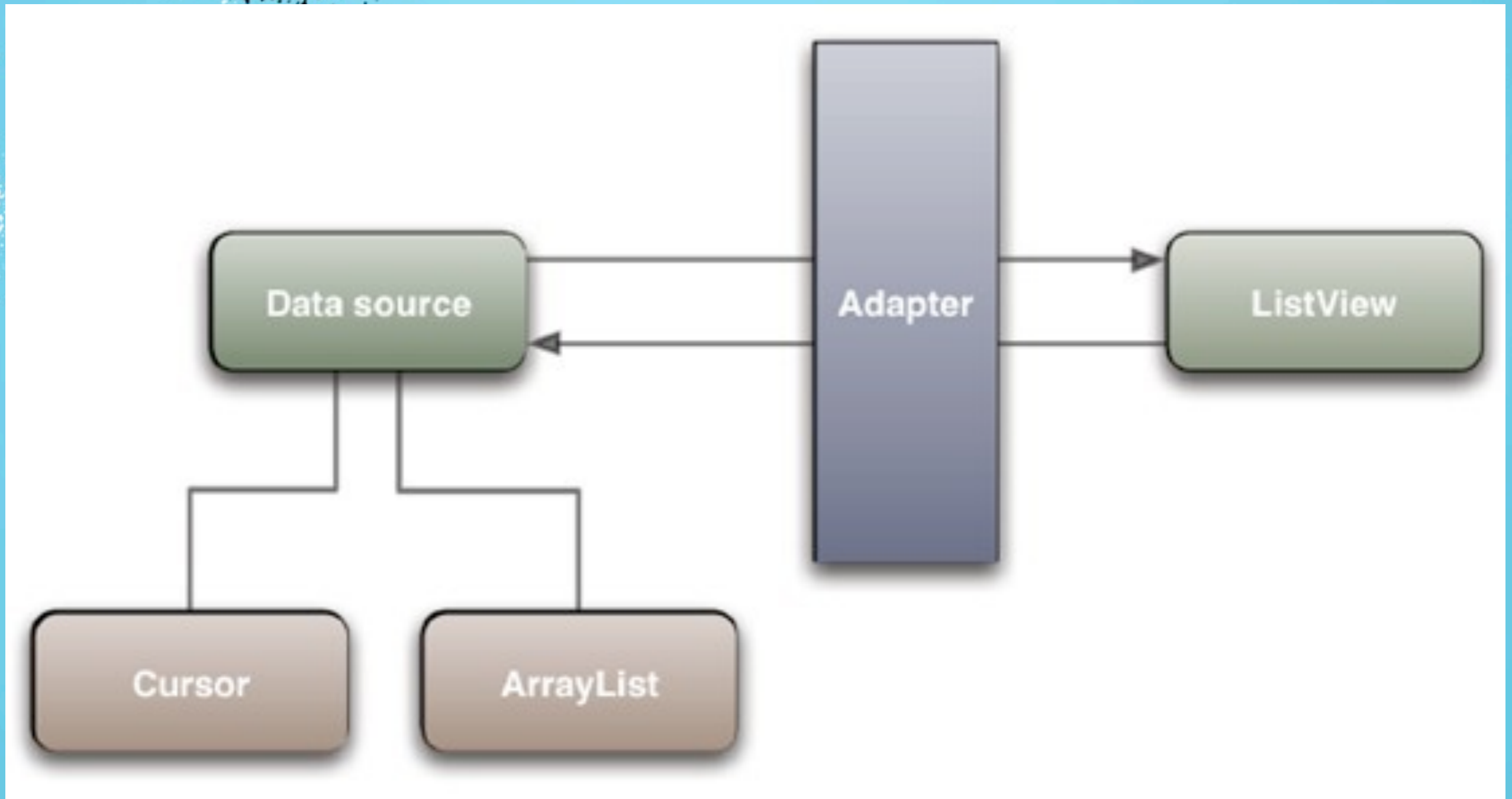

FORM WIDGETS

TextView

Write a review

Enter review here.

★ ★ ★ ★ ★

Accept Close

EditText

RatingBar

Buttons

14:18

Button

Button

Button

Button

Button

Button

Checkbox

Choose a color

Red

Green

Blue

Green set to true

FORM WIDGETS 2

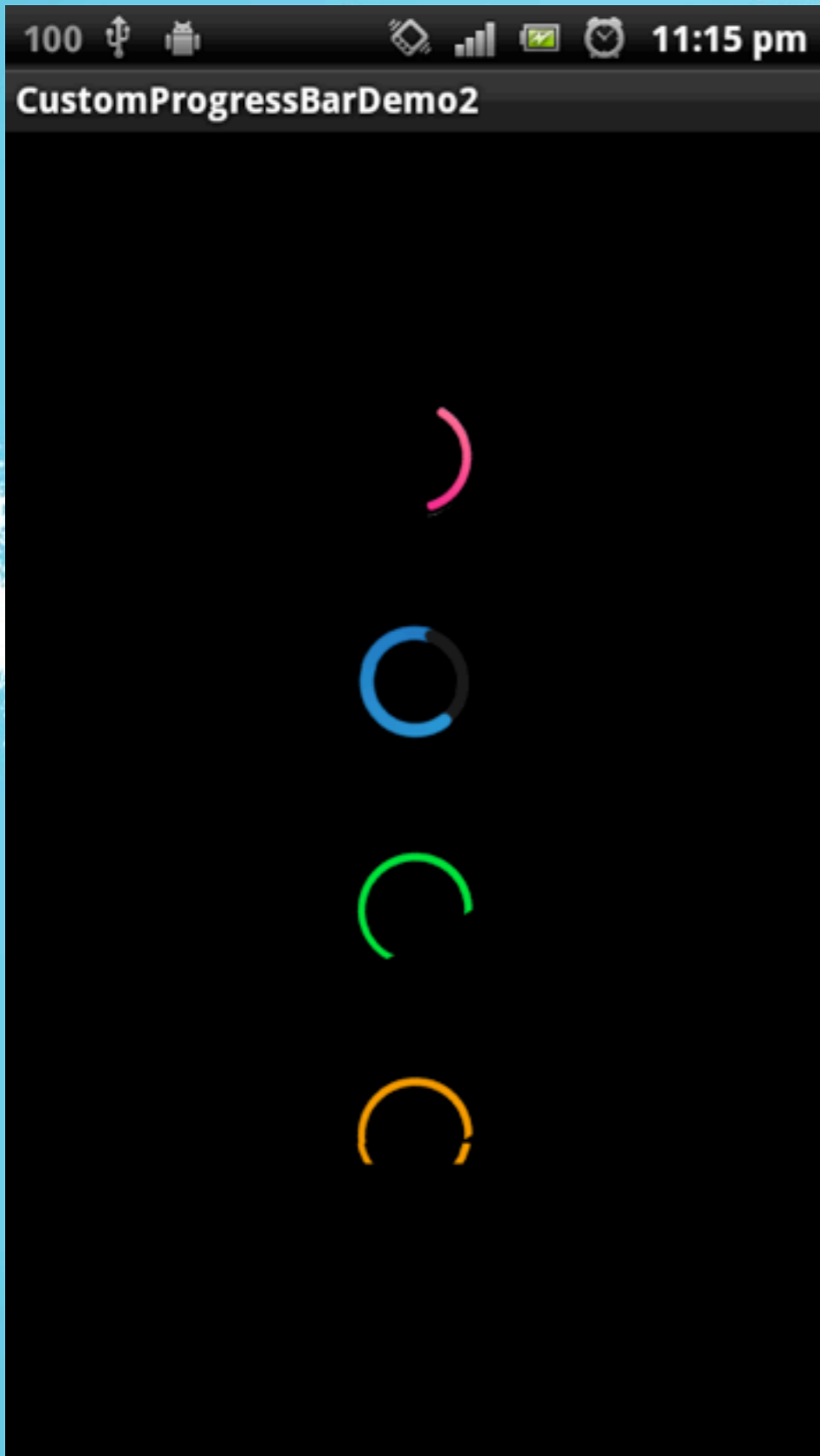

GALLERY

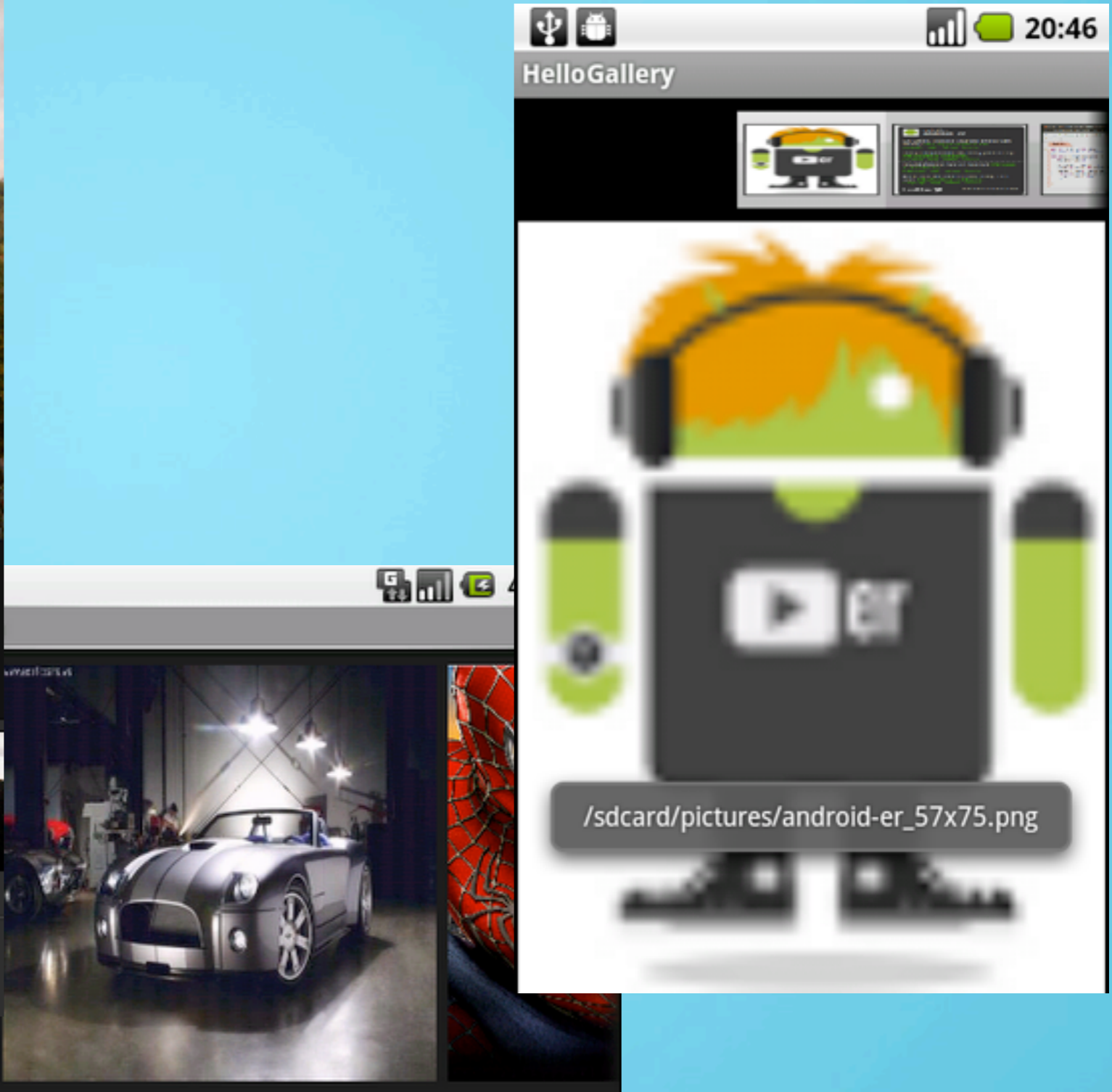
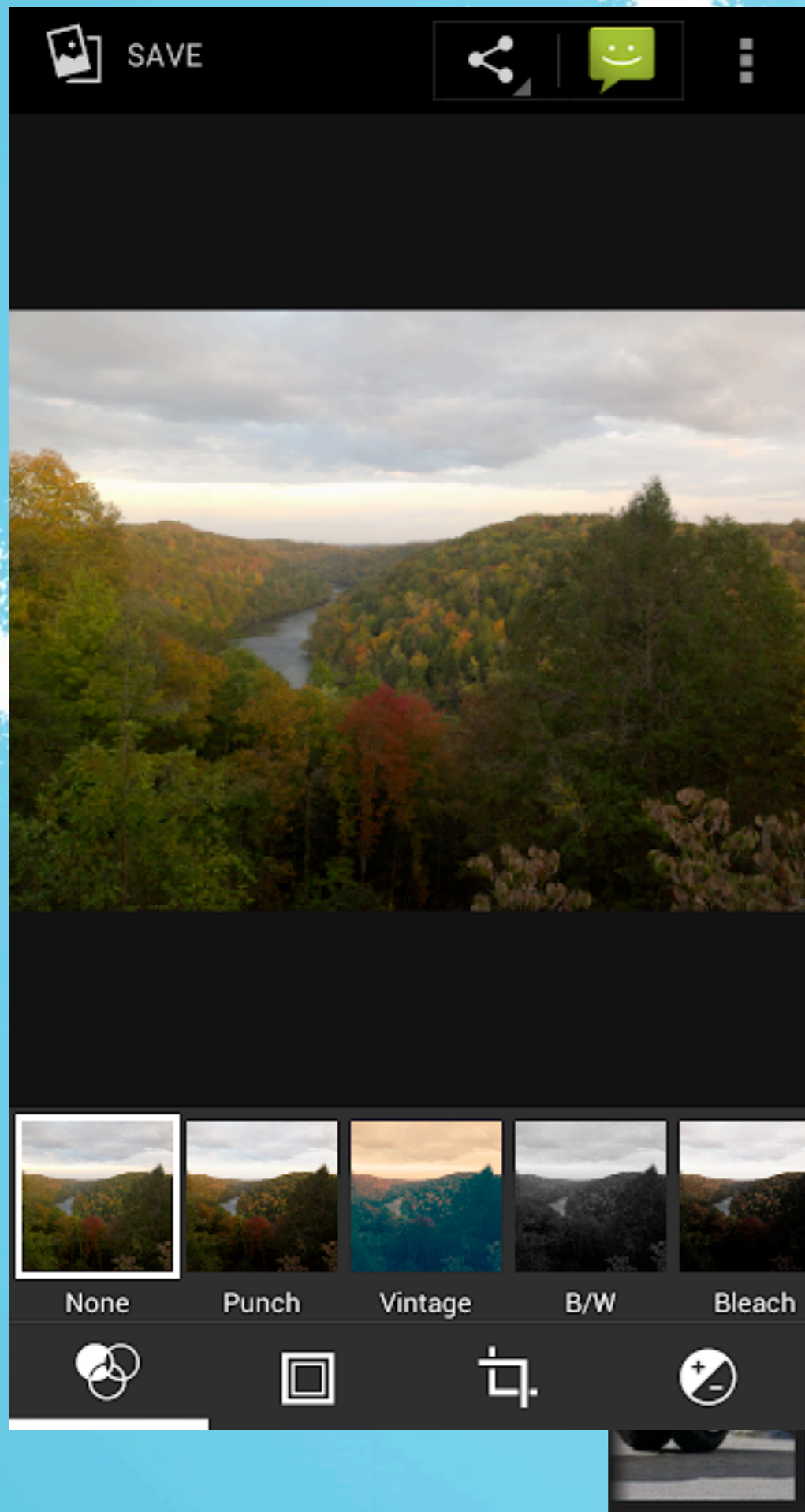

DATE / TIME PICKERS

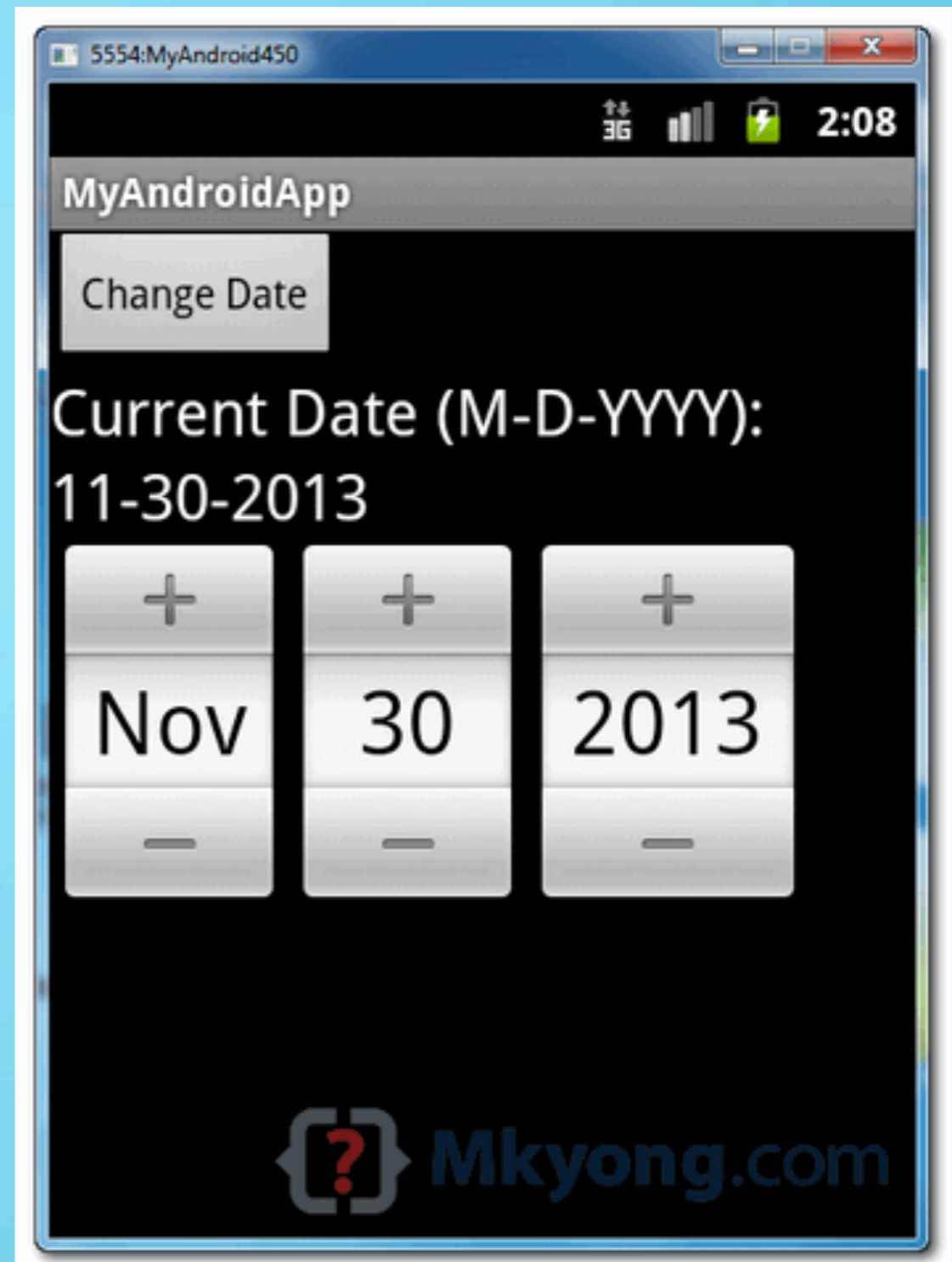
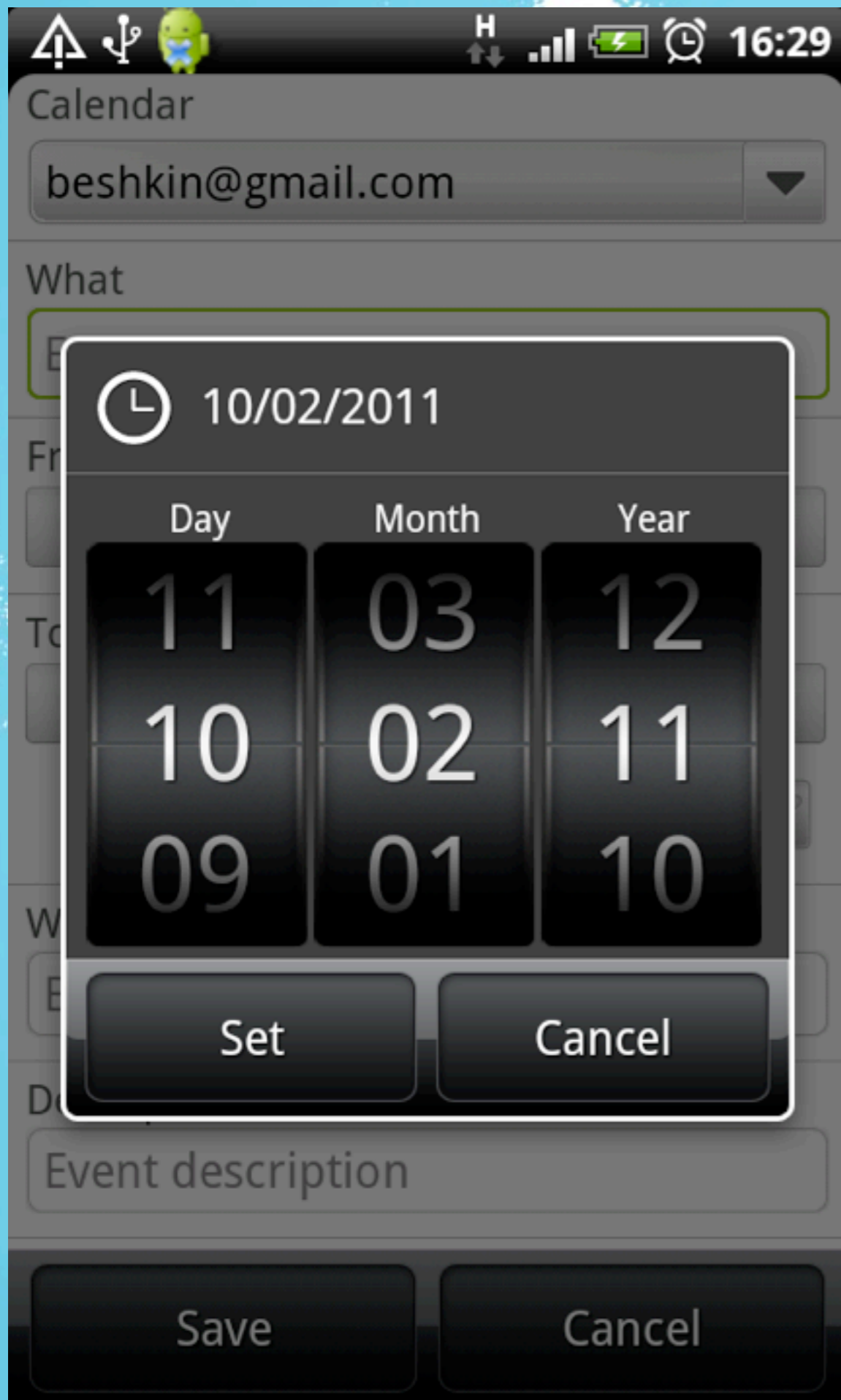

GESTUREOVERLAY VIEW

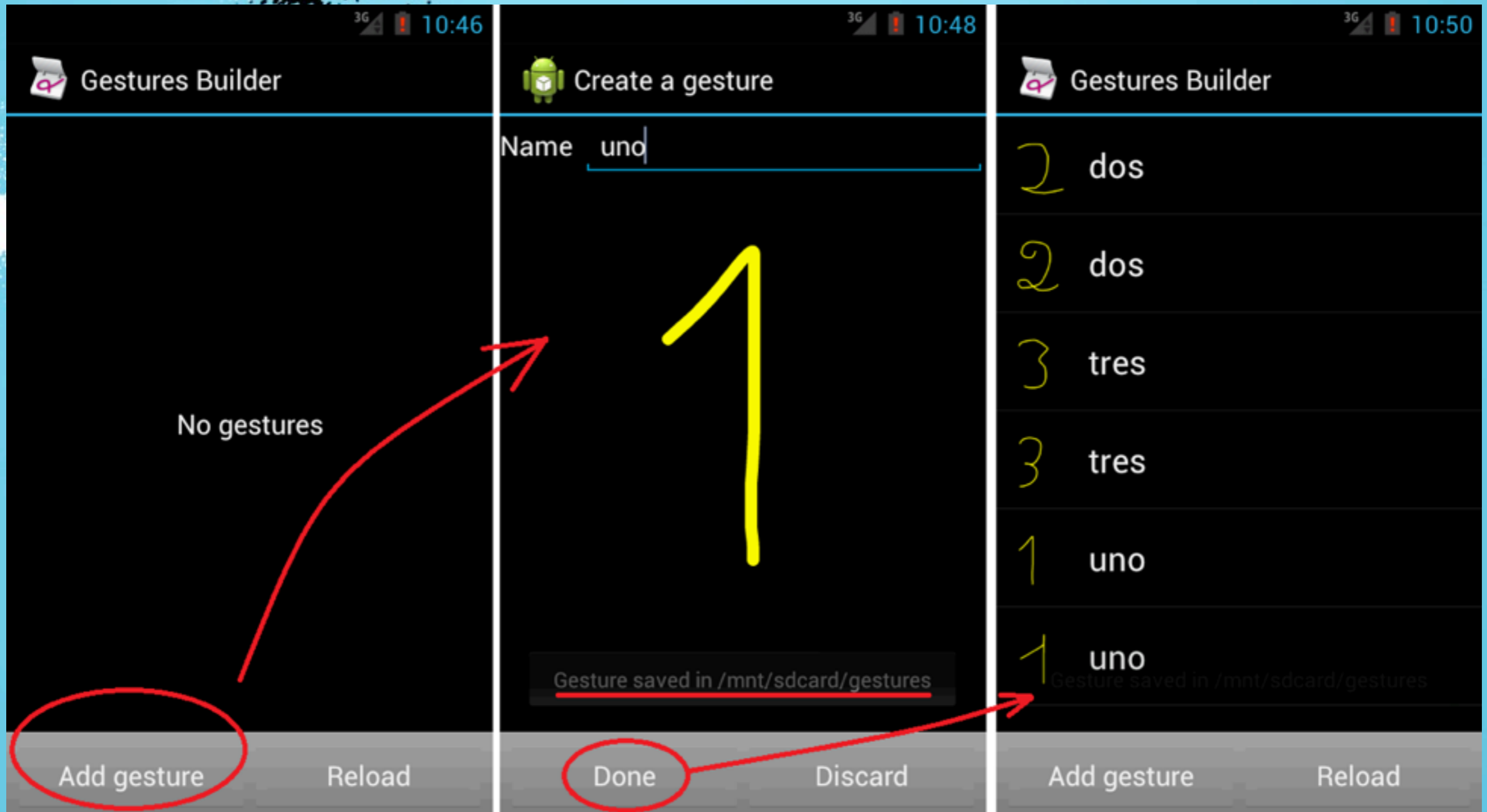

9PATCH

9-patch guides

what do they do?

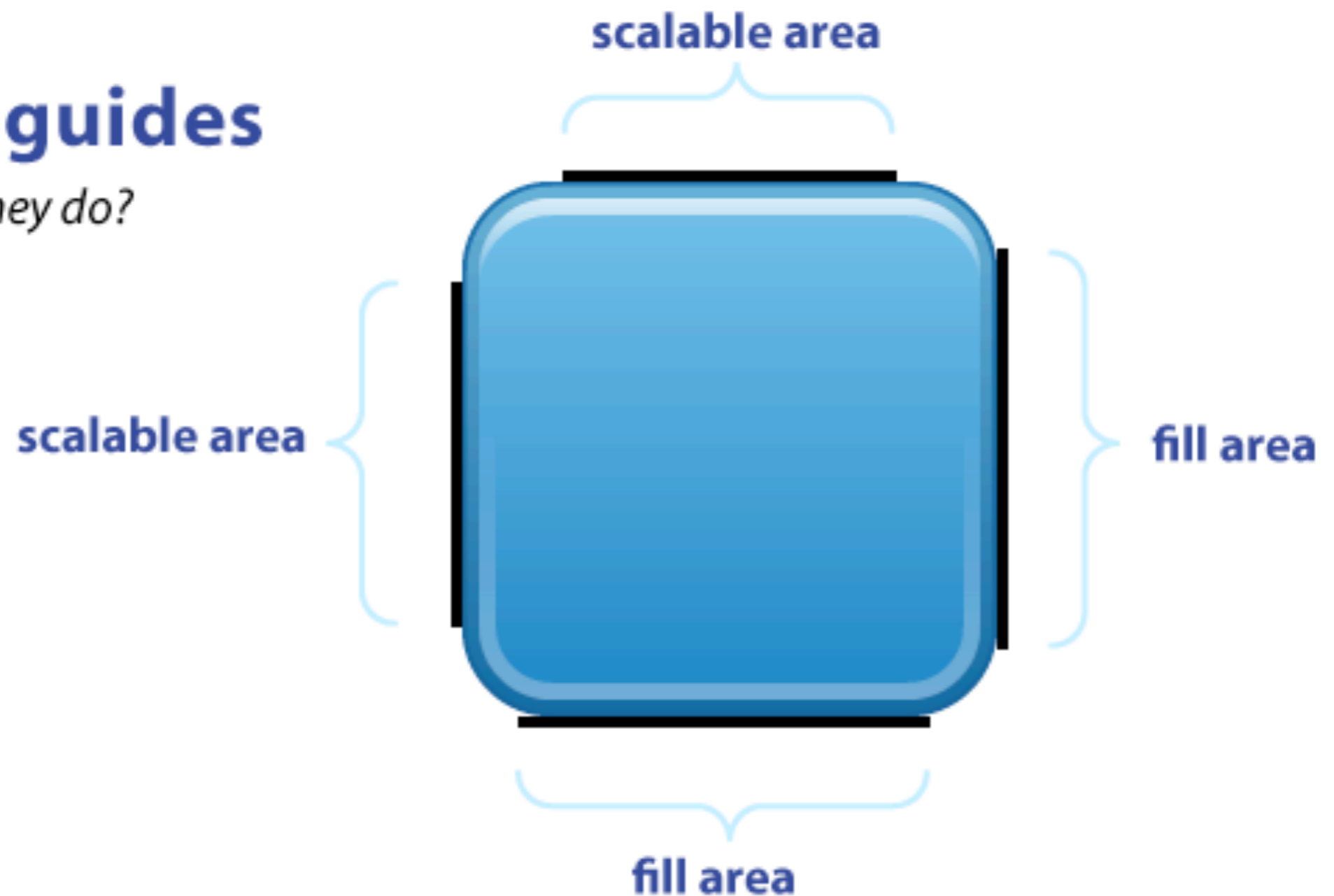

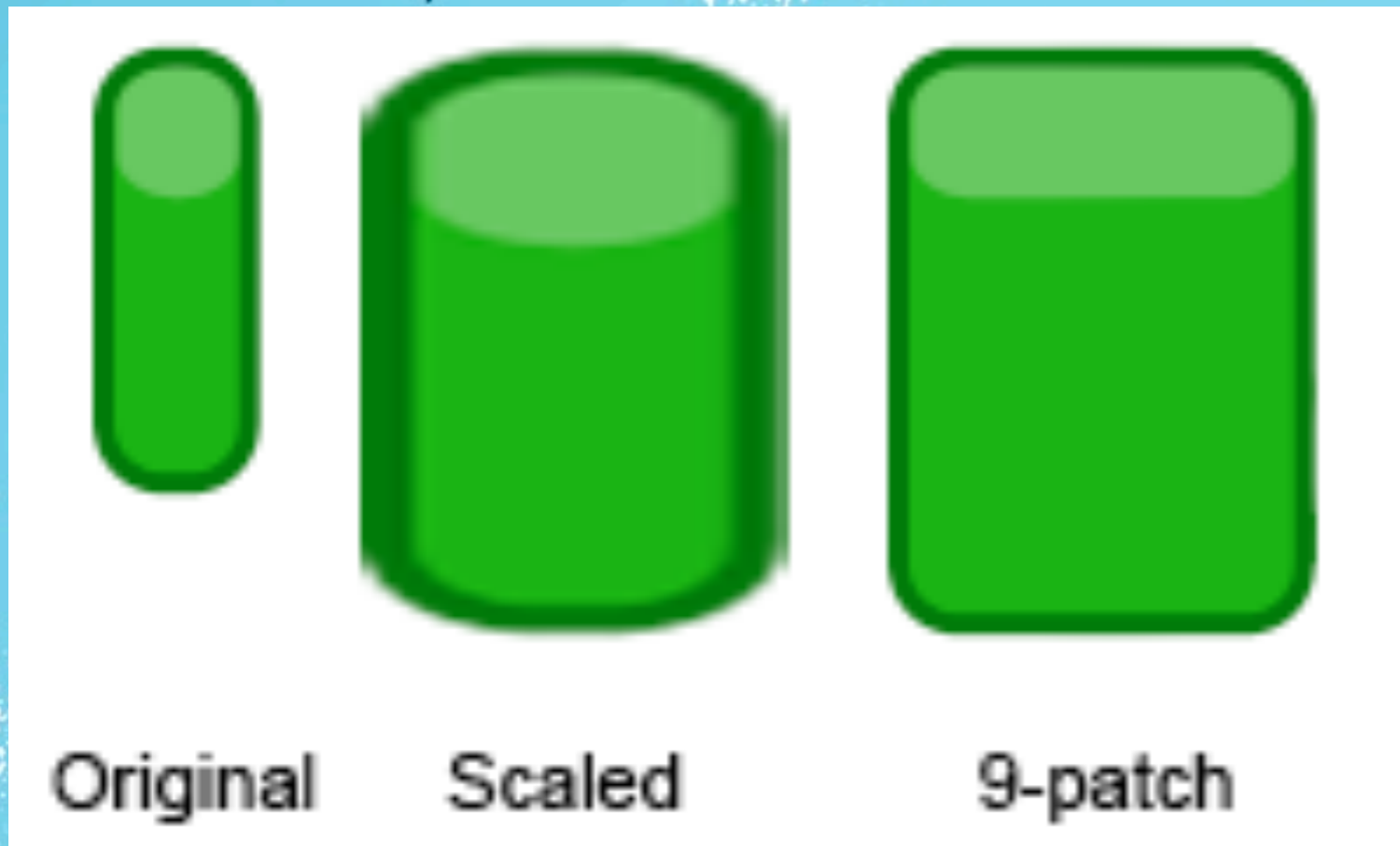

9PATCH

- Background image resources
- Buttons, Large areas
- Resizes for purpose
- Could be replaced by `NinePatchDrawable`